



2025-26 UPPER LOT BEACH STICKER APPLICATION- **METTAWA RESIDENTS**

*(Valid from April 1 - March 31. Excludes North and Lower South Lots)*

Please Print

Name \_\_\_\_\_

Address \_\_\_\_\_

City, Zip \_\_\_\_\_

Phone \_\_\_\_\_

Resident eligible to receive a maximum of one sticker per address.

Regular Fee

\$ 85.00

\$ 42.50 *-After 8/1*

Replacement/Transfer Fee  
*(decals must be surrendered)*

\$ 5.00

FOR CITY USE ONLY:

Total Paid \_\_\_\_\_

Issued By \_\_\_\_\_

Date Issued \_\_\_\_\_

Half Price \_\_\_\_\_

(after 8/1)

Permit Number  
\_\_\_\_\_

MOTOR VEHICLE:

Year \_\_\_\_\_ Make \_\_\_\_\_

Model \_\_\_\_\_ Color \_\_\_\_\_ State Plate Number \_\_\_\_\_

In consideration of the issuance of a permit upon this application, I hereby certify to the correctness of the information on this application. I have read and agree to abide by all the ordinances, rules, regulations, and conditions of this application governing the use of the beach and parking areas. I release and forever discharge the City of Lake Forest, its officers and employees from any and all liability for any loss, damage, or injury to persons or property arising in any manner out of the issuance of this permit.

Date \_\_\_\_\_ Signature \_\_\_\_\_

Please make check payable to: The City of Lake Forest. Return completed application, with check, in person or mail to The City of Lake Forest, 800 N Field Dr, Lake Forest IL. 60045. Questions? Please call 847-810-3622.

-----  
(Detach at dotted line. Return upper portion to The City of Lake Forest for processing)

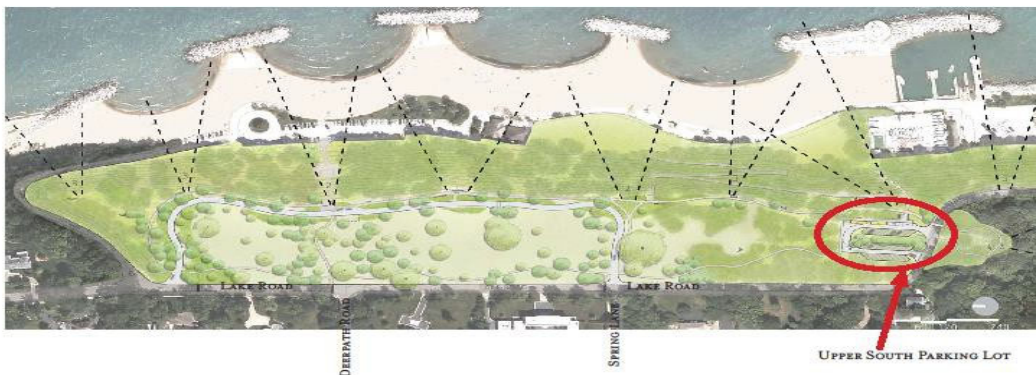

For questions related to Beach Parking, Beach Operations and Events, please contact the Recreation Department or visit their website at: <https://lfparksandrec.com/>

# FOREST PARK



**LAKE FOREST**  
 PARKS AND RECREATION

400 Hastings  
 Lake Forest, IL 60045  
 phone: 847.234.6700  
 Contact Us

© 2019 Lake Forest Parks and Recreation  
 All rights reserved. Site by PUREi